



# meetings & events.

Your unforgettable event experience.



Your next event in one word.  
Brilliant.

Pearl Riverfront is Melbourne's newest premier event destination. Located right on the Yarra River with ten flexible event spaces this specially designed venue situated beneath one of Melbourne's iconic buildings, Crowne Plaza Melbourne, caters to residential conferences, seminars, speakers lunches, product launches, trade exhibitions, meetings and special events. From on river projection, helicopter flyby, to arrivals by boat and celebratory fireworks; your event execution is only limited to your imagination.

Pearl Riverfront brings exceptional, extraordinary, curated, and inspirational to the planning where your next event in one word is; brilliant.

brilliant.





venue.



# Our Venue

Be it a corporate conference or trade show, sit-down dinner or cocktails and canapes for up to 700 guests – at Pearl Riverfront we know how to make every detail your own. How do we create an event beyond your expectations? We collaborate with you to bring your event to life, in a destination you’ll feel proud to be a part of.

With six interconnecting studios riverside and four dedicated meeting spaces in the Atrium; our event spaces can be tailored to perfectly cater to the needs of your event. The newly refurbished and modern space features state of the art audio-visual, sound and lighting technology with a dedicated Event Staging Manager on-site to assist with your additional requests.

Your dedicated Event Manager will work collaboratively with you to ensure all of the finer details are delivered, making your event memorable and brilliant.



# Capacity Chart



Room	Room size	Ceiling height	Banquet	Cabaret	Reception	Theatre	Classroom	Boardroom	U-Shape	Trade Exhibit
Level 1 - Pearl Riverfront Studios										
Studio 1	143.7m²	2.65m	60	42	155	90	57	18	21	✓
Studio 2	145m²	2.65m	80	56	165	142	60	18	24	✓
Studio 3	142m²	2.65m	80	56	160	131	60	18	24	✓
Studio 4	142m²	2.65m	80	56	160	139	60	18	24	✓
Studio 5	145m²	2.65m	80	56	165	136	60	18	24	✓
Studio 6	141m²	2.65m	80	56	160	142	60	18	24	✓
Breakout (can only be hired with Studios 1-6)	68m²	2.65m	-	-	-	-	-	-	-	✓
Studios 1-6* (combined rooms)	926.7m²	2.65m	452**	322	452**	452**	350	-	-	✓
Studios 1-3* (combined rooms)	430.7m²	2.65m	220	154	452**	452**	170	-	-	✓
Studios 4-6* (combined rooms)	428m²	2.65m	240	168	450	410	180	-	-	✓
Pre-function area	385m²	2.65m	-	-	244	-	-	-	-	✓
Pre-function area + Studios 1-6*	1311.7m²	2.65m	-	-	696-	-	-	-	-	✓

## Level 3 - Atrium Rooms

Atrium One (Meeting Room)	64m²	3.62 min   8.40 max	40	28	70	50	30	12	16	-
Atrium Two (Boardroom)	74m²	3.62 min   8.40 max	20	-	12	-	-	14	-	-
Atrium Three (Boardroom)	74m²	3.62 min   8.40 max	20	-	12	-	-	14	-	-
Atrium Four (Meeting Room)	64m²	3.62 min   8.40 max	40	28	70	50	30	12	16	-

### Terms & Conditions

All capacities are approximate numbers based on calculated floor space.

All COVID-19 regulatory restrictions must be adhered to and compliant on the day of the event.

\*\* Full capacity of Level 1 combined spaces is based on official liquor licensing approved numbers. Individual studios are calculated at full capacity based on square meterage.

- Capacity of entire Level 1 space requires the doors to be left open to accommodate combined total capacity of guests.

^ Atrium Rooms capacities to be confirmed upon completion in January 2021.

# Floorplans

## Studios 1-6

Designed for versatility, each interconnecting studio can be transformed to cater for 18 guests boardroom style, or up to 452 guests when combined banquet style.

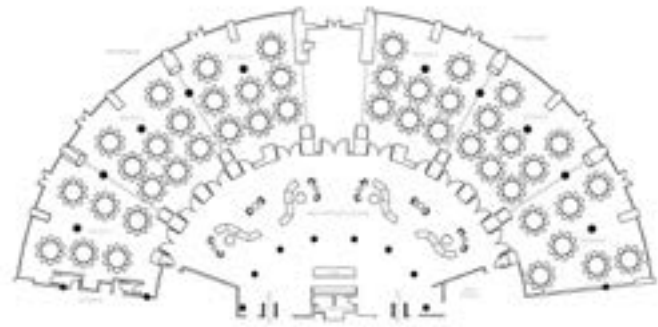

## Studios 4-6

Delivering greater flexibility and use of space, Studios 4-6 combined can cater for up to 410 guests theatre style.

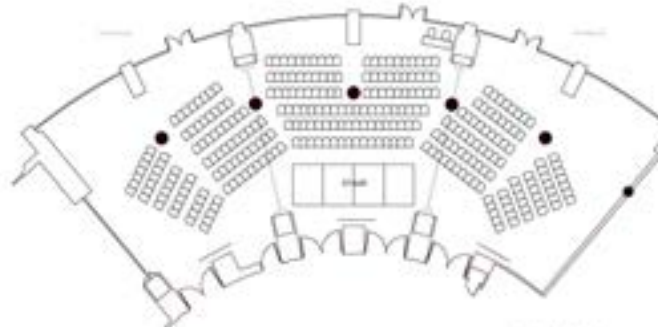

## Atrium

Ideal for board meetings, co-working sessions and private dinners, the bespoke Atrium Rooms offer the utmost privacy for up to 40 guests banquet style.

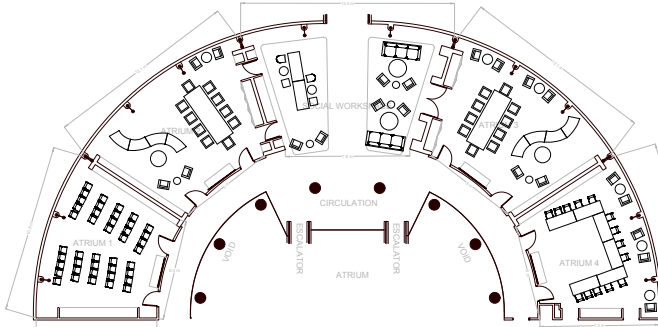





packages.



# Day Delegate Package

## 95pp

Minimum 10 guests. This package includes:

- Dedicated Event Planner
- Up to 8 hour room hire\*
- Complimentary bottled water at each reset
- Freshly brewed Victoria Coffee and speciality tea selections
- Chef's selection morning and afternoon tea refreshments
- Chef's table lunch
- Notepads and pens

# Half Day Delegate Package

## 75pp

Minimum 10 guests. This package includes:

- Dedicated Event Planner
- Up to 4 hour room hire\*\*
- Complimentary bottled water
- Freshly brewed Victoria Coffee and specialty tea selections
- Chef's selection of either morning or afternoon tea refreshments
- Notepads and pens

\* Full day room hire held between 6am – 5pm

\*\* Half day room hire held between 6am – 12pm or 12pm – 5pm





# Banquet Package 150pp

Entertain your guests with a touch of elegance. This package includes:

- Dedicated Event Manager
- Selection of three canapes per person
- Three course set dinner menu including an alternating main course
- Freshly brewed Victoria Coffee and speciality tea selections
- Selection of ganache chocolates
- Five hour Silver Beverage package
- ‘Styled Your Way’ room styling
- Special accommodation discount for guests

# Cocktail Package 95pp

Mix and mingle along the river’s edge. This package includes:

- Dedicated Event Manager
- Three hour cocktail event with eight canapes and three substantial dishes per person
- Four hour Silver Beverage package
- High bar tables and tealight candles
- Special accommodation discount for guests

# Tradeshow & Exhibition Package 85 per Exhibitor

Host your event in a space built on versatility with modern technology, includes:

- Organisers arrival breakfast coffee and muffin, morning tea, lunch, afternoon tea
- Secretariat room
- Room hire, bump-in and bump-out to be quoted per event

Exhibitors:

- Daily arrival coffee and pastries (two days)
- Two hour opening exhibitors cocktail event including seven canapes and one substantial dish per person
- Silver Beverage package
- High bar tables and tealight candles
- Special accommodation discount for exhibitors
- Option for exhibitors to organise daily catering to their stand

# Styled Your Way

Our Event Planner will ensure your event is styled the way you imagined providing exclusive access to Pearl Riverfront’s handpicked team of partners and suppliers; personalised quotes can be sourced on your behalf.

Lead in packages include the following styling elements:

- Personalised table menus in Pearl Riverfront folders
- Black or white table linen
- Crockery and cutlery
- Access to boardwalk and riverfront for photography and areas of Crowne Plaza Hotel

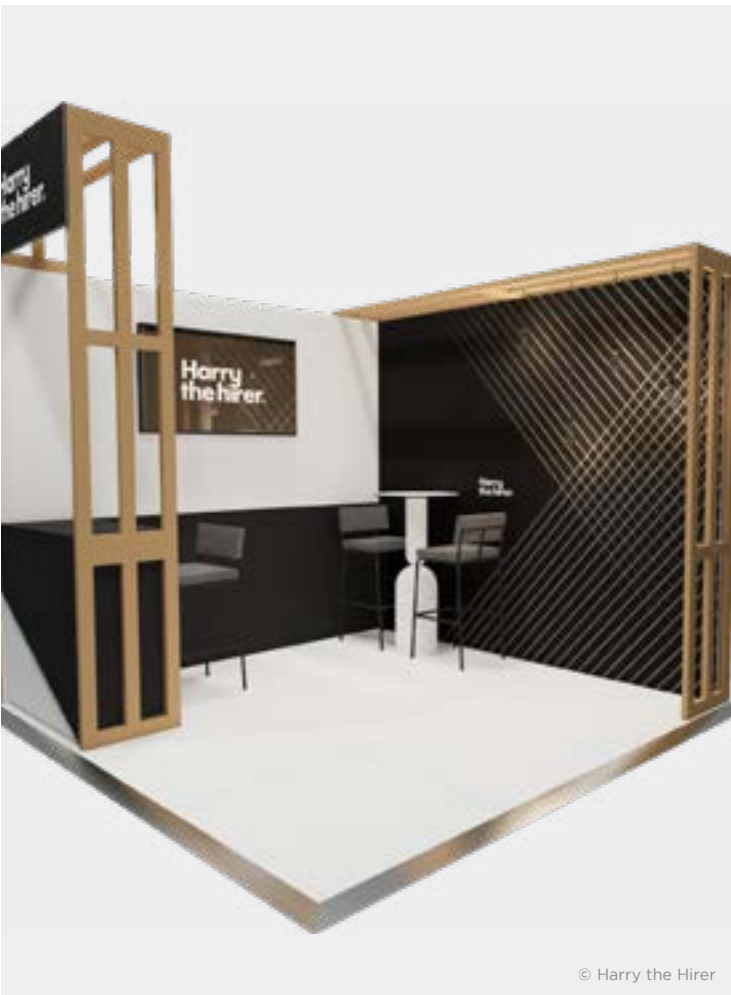



# Hybrid & Virtual Event Solutions

Whether it's due to travel restrictions or personal circumstances, the need to take your meeting digital has become a reality. Having a specialised team that enables you to keep meeting objectives on track may be critical to the success of your event. In conjunction with Av Partner, Encore Technologies, we can help the show go on even if a key presenter or some of the attendees are unable to attend in person.

Our solutions help you stay connected today enabling you to connect guests from different locations to experience the same seamless event. In fact, virtual and hybrid events offer many benefits including sponsorship opportunities and the increased ability for audience engagement.

From live streaming, audience polling, video conferencing, webcasting, event apps and more, we have the solution for a successful hybrid event.



# Breakout Spaces

When additional space is required, take advantage of our dedicated pre-function area or riverside boardwalk.

Our dedicated pre-function area can cater for up to 244 guests reception style, making for the perfect space to mix and mingle during a breakout lunch or where to treat your guests to arrival champagne before the official proceedings of your event. The pre-function area is fully equipped with a dedicated bar where the Pearl Riverfront team will be delighted to cater to your special requests, the best they can.

As an event host at Pearl Riverfront, we invite you to take advantage of the riverside boardwalk directly in front of the venue. The boardwalk offers the ideal space for transitioning your event from day to night, whether it be an elegant cocktail party or relaxed garden party partitioned off from the public.

The riverside boardwalk can be utilised should you wish for guests to arrive by riverfront where on river projection, helicopter flyby, to arrivals by boat and celebratory fireworks can be arranged.



# Culinary

Be transported by your senses and experience our culinary team’s creativity in delivering art to your plate. Our culinary vision is to pay homage to the iconic architectural building the venue sits within - highlights of boldness, dare to be forward in design and sustainability. Every dish a delight to your sight, and each mouthful dances on your palate.

The best sustainable produce sourced locally from our farms and oceans; culminating architecture in its form, layers of textures with tantalising flavours.

Be inspired, be curious, be delighted.





# Yugo Melbourne

Yugo is rooted in storytelling. From the food Chef Matthew Butcher dreams up with the culinary team, inspired by his travels around the world and through Japan, to the beverage program complete with a list of storied wines full of personality, sourced from the far reaches of the world and Australia. Each meal is an experience at Yugo - a story that the passionate staff are excited to share every day.

Yugo’s private dining room is the ultimate space for an intimate dinner for 8 – 12 guests. Our unique Cube frosts at the click of the button, allowing a completely immersive experience where diners are encapsulated in a private room amongst a bustling restaurant. Our private space heightens the sensory dining experience, as all other distractions are removed whilst you dine within the Cube.

# Dive Bar

Dive Bar has the personality of a cool kid that grew up and developed a discerning taste. Featuring an imaginative cocktail list, with a menu of small plates sure to tempt, Dive Bar is where guests and locals know they’ll have a good time. It’s the place to socialize and play into the late night and to dance to your favourite tunes on our custom-designed jukebox.

# Pow Wow

Pow Wow—slang for a conference or meeting for discussion, especially among friends or colleagues—will be a third-place for the city. With a California-inspired design that’s fresh and bright and a vibe that’s relaxed and cozy, both locals and guests alike will treat Pow Wow like their very own living room from day to night.







## Take your event to new heights.

Crowne Plaza Melbourne is the only absolute riverfront hotel in Melbourne. Boasting 432 modern guest rooms and suites, your guests may choose to retire and unwind in the comfort of their own room after your event at Pearl Riverfront.

Designed to bring elements of the city's rich cultural history inside the hotel, guest rooms are fitted with contemporary furnishings and Melbourne inspired artwork. Each guest room offers either a king bed or twin share, with city-skyline or river views. Your guests will wake up feeling refreshed and enjoy complimentary in-room pod coffee to kick start their day.





**Pearl Riverfront**

at Crowne Plaza Melbourne  
1-5 Spencer Street, Melbourne VIC 3008  
(03) 9620 5000  
[events@pearlriverfront.com.au](mailto:events@pearlriverfront.com.au)  
[pearlriverfront.com.au](http://pearlriverfront.com.au)

An IHG managed venue